



SPINNING COASTER



REFERENCE RC72

TECHNICAL DATA

Manufacturer: Italian

Manufacture Date: 2003

Capacity: 20 passengers Back to Back

Train: 1 train connect as 5 cars with 4 seat each

Status: Operating

Drive system: Electronic Motor

Brake system: Pneumatic System

Max Speed: 100Kph

Power Motor: 220V 3ph

Total weight: 25,000KG Approximately

Transportation: Container van 40' N°4 not included.















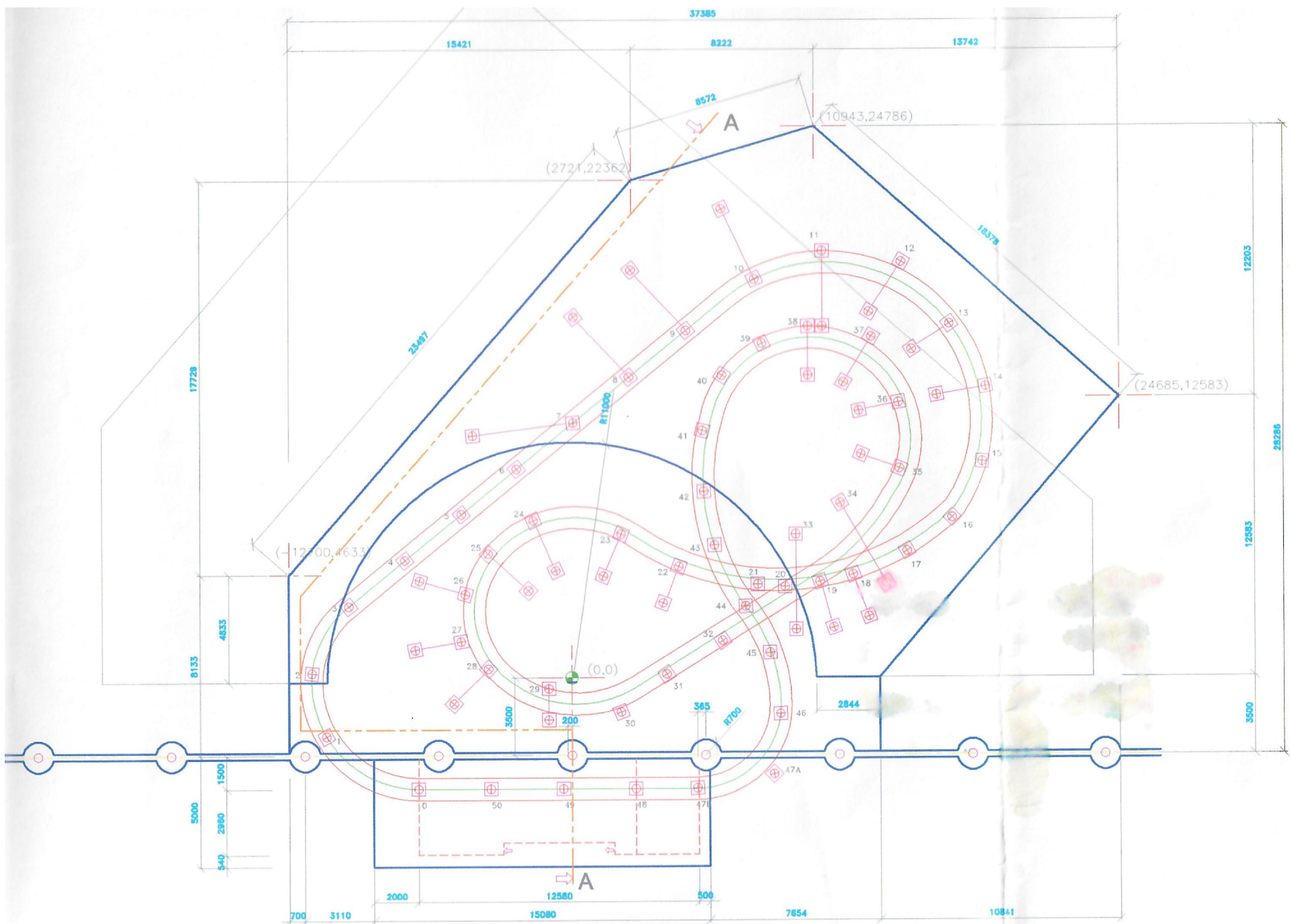

FUN TIME ROLLER COASTER – FOUNDATION

SCALE

1:1000